



## The acoustic insulation is characterized by three different types of insulation - Insulation from percussion noises

The insulation of percussion noises is the reducing of the sound level originated from the impacts on the slabs, that are transmitted to the immediately lower storey.

For an effective reduction, a total inde-

pendence, between the flooring and the remaining structure, must be ensured.

The interposition of an elastic element, the Expanded Cork Board, between the flooring and the slab, makes a reduction in the transmission of vibrations and

noises resulting from impacts.

It will also be important to maintain the discontinuity between the flooring screed and the adjoining walls, thereby eliminating marginal transmissions.



### INSULATION OF PERCUSSION NOISES

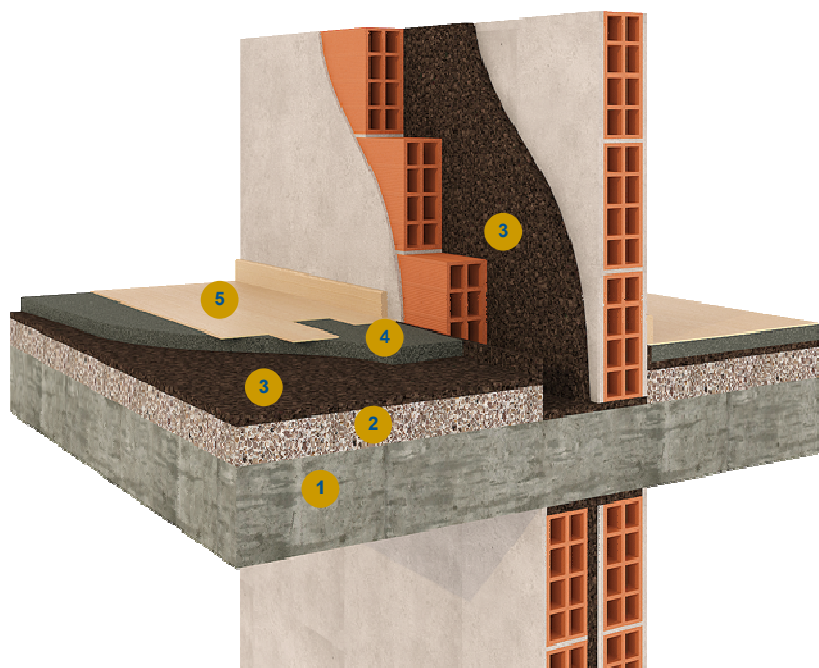

- 1 Slab
- 2 Light weight concrete
- 3 Expanded cork board - ICB
- 4 Screed
- 5 Final pavement

#### Benefits

Excellent sound correction

High reduction in overhead and percussive noises

Avoids the propagation of existing vibrations

#### Overhead noise reduction

11 cm double wall  
+ 4 cm cork - ICB in the air gap

RW = 53 dB

#### Impact noise tests

14 cm concrete slab  
7 cm light weight concrete, with granulate of expanded cork  
2 cm expanded cork - ICB  
4 cm screed + final pavement

Ln, r, w = 55 dB